



IDST (Silverback) Bluetooth Headset User Manual

Contents

Thank You	2
Please Read this Reference Manual	2
Features	2
Charge the Battery	3
Battery Extraction	4
Connecting Headset to Device	4
Pairing	4
Custom User Functions	5
Changing Language	5
Microphone Mute	5
End Call	5
Voice Activation	5
Understanding LED Lights and Tones	5
Position the Boom	6
Adjust Headband	7
Headband Disassembly	7
Install Windscreen and Ear Cushion	8
Microphone Orientation	8
Patents	9
Operating Specifications	9
Cleaning and Maintenance	9
Troubleshooting	10
Battery Safety Guidelines	11
Warranty and Customer Support	11
Safety and Regulatory Information	12

Thank You

We appreciate your purchase of the IDST (Silverback) Bluetooth Headset. This rugged wireless Headset combines high-quality audio performance, environmental durability, and lightweight comfort without sacrificing stability during active use.

Please Read this Reference Manual

Please take the time to follow the instructions in this reference guide carefully. It will help you set up and operate your Headset properly and enjoy its advanced features. Please save this guide for future assistance.

Features

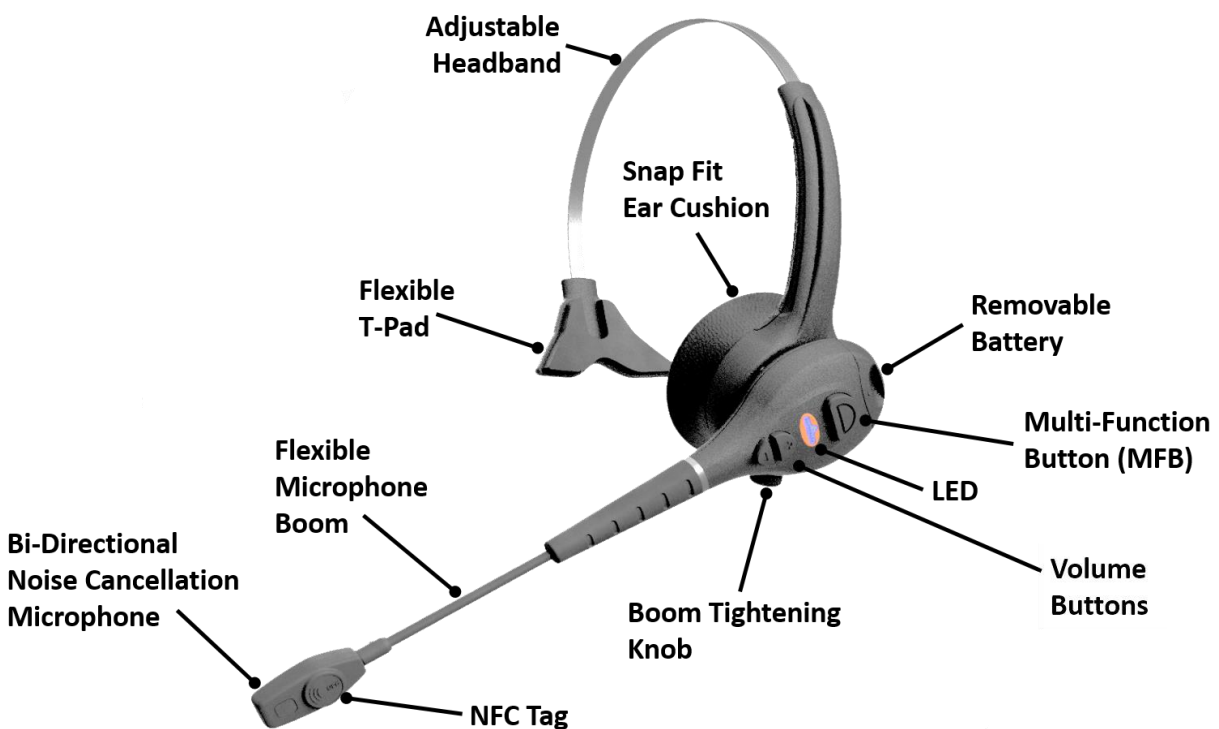

Charge the Battery

1. Connect charging cable plug into 10-Bay Charger.
2. Insert AC Adapter into Power Outlet.
3. Charge Battery for 3 hours prior to use.

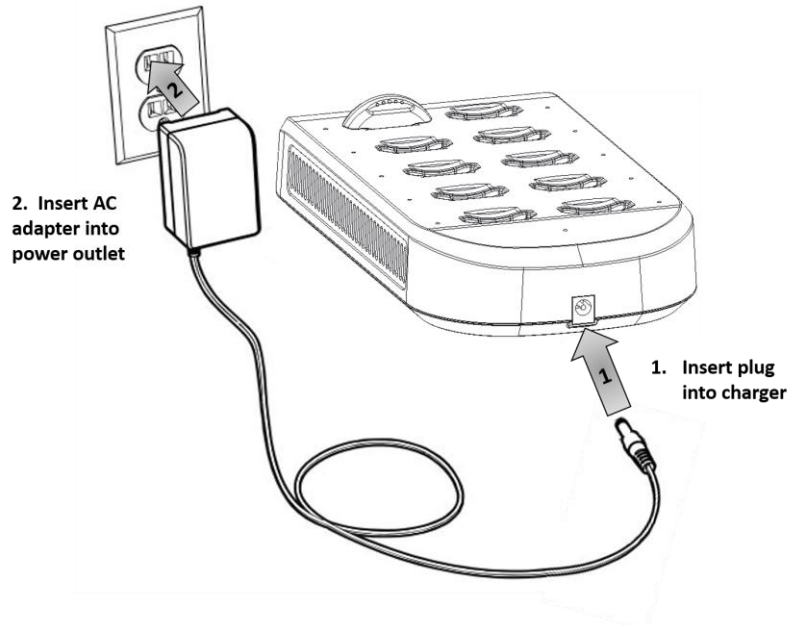

Battery Insertion

1. Rotate Boom 45 degrees to stop position.
2. Insert battery into headset until firmly seated.



Battery Extraction

1. Pivot Headset Module 45 degrees downward until it stops.
2. Remove Battery from Bluetooth Headset Module.



Connecting Headset to Device

To use the IDST (Silverback) Bluetooth Headset with a Bluetooth Device (or “Host”), such as a mobile computer or industrial tablet, you must first establish a wireless connection between the Headset and the intended Device. This process is called “Pairing”. In order to eliminate accidental connection to devices in a congested area, headset will store only 1 Mac Address.

Pairing

The Headset may be paired with Bluetooth devices in the following three ways:

1. Standard Bluetooth pairing where the headset is discovered by the Host.
2. Touch-to-Pair with devices supporting an NFC Connection.
3. Scan-to-Pair with devices supporting Bluetooth Mac Address Scanning.

Headset must be within close proximity of the host to complete pairing. To initiate pairing, Headset must be powered off. If the headset is on, turn off by pressing the Multi-Function Button (MFB) for 2.5 seconds.

1. Initiate Standard Bluetooth pairing by pressing the Multi-Function Button for 5.5 seconds until you hear “Pairing” and the LED alternately flashes red and blue. Use the Host’s Bluetooth search and pairing functionality (refer to the Host documentation if necessary) and select “**SILVERBACK**”. If necessary, enter four zeros (0000) for the passcode and accept connection.
2. For Touch-to-Pair, **initiate Standard Bluetooth Pairing before** touching Headset NFC tag to NFC tag of Host. NFC Tag is located in Microphone Assembly.
3. For Scan-to-Pair, **initiate Standard Bluetooth Pairing before** activating Host scanning function and scan Headset Bluetooth Mac Address Barcode Label.

Once successfully paired, you will hear “Pairing Successful” and the LED will flash blue, once every two seconds indicating the Headset and Host are connected. The Headset may be paired to a new Host using the above procedure. Note that this will undo the pairing to the current Host.

Once the Headset and Host have been paired, the Headset and Host will automatically reconnect the next time they are both powered on and in close proximity to each other.

Custom User Functions

Changing Language

Change Language by pressing Multi-Function Button (MFB) and Vol+ for 1 second. This function can only be activated in standby or connected mode. IDST (Silverback) Bluetooth Headset supports the following languages: English, French, German, and Spanish.

Microphone Mute

During phone calls, the microphone can be muted by pressing Vol+ and Vol- for 1 second. User will hear a prompt “Mute On”. A double tone will alert user every 10 seconds that the microphone is muted. Pressing Vol+ and Vol- for 1 second will deactivate the Microphone Mute function. User will hear a prompt “Mute Off”.

End Call

To end a call, press the MFB for 1 second.

Voice Activation

To initiate the hosts Voice Recognition, double press the MFB.

Understanding LED Lights and Tones

Primary Features	Headset Control	LED Light	Tones
Pairing	Powered Off, Press MFB for 5 Seconds	Blue and Red Alternate Flash	“Pairing”
Pairing Complete	Automatic	No LED Output	“Pairing Successful”
Pairing Failure	Automatic	No LED Output	“Pairing Incomplete”
Power On/Off	Press MFB for 2.5 Seconds	Blue/Red Flash 3 Times	“Power On”, “Power Off”
Volume	Press Volume + or Volume - to Increase or Decrease Volume	No LED Output	< Increase Volume >Decrease Volume
Connected	Automatic	Blue Flash Once Every 2 Seconds	Double Short
Microphone Mute	Press Vol+ and Vol- to Mute/Unmute	No LED Output	“Mute On”, “Mute Off”
Change Language	Press MFB and Vol+ for 5.5 seconds	No LED Output	“English Selected”
Not Connected	Automatic	Blue Solid	“Lost Connection”
Link Lost	Automatic	No LED output	“Lost Connection”
Low Battery Warning	Automatic	Red Flash Twice Every 2 Seconds	“Battery Low”
Low Battery Shutdown	Automatic	Red Flash 3 Times	4 Descending

A/V Playback Features	Headset Control	LED Light	Tones
A/V Streaming	Automatic	Blue Flash Twice Every 2 Seconds	N/A
Play or Pause	Press MFB for 0.5 Seconds	No LED Output	Short High
Track Forward	Press Volume Up for 1 Second	No LED Output	Short High
Track Backward	Press Volume Down for 1 Second	No LED Output	Short High
Phone Call Features	Headset Control	LED Light	Tones
Answer/End Call	Press MFB for 1 Second	No LED Output	One Short/Two Short
Call Ongoing	Automatic	Blue Flash Once Every 3 Seconds	N/A
Ignore 1 st Call/2 nd Call	Press MFB for 1 Second	No LED Output	Long Low
Answer Second Call/Hang up Ongoing Call	Double Press MFB	No LED Output	One Short
Answer Second Call/Hold Ongoing Call	Double Press MFB	No LED Output	Long Low
2 nd Call Ongoing	Automatic	Flash Red On 1 Second, Off 1 Second	N/A
Transfer Audio Between Headset and Host	Triple Press MFB	No LED Output	N/A
Last Number Redial	Press Volume + and Volume – for 0.5 Seconds	No LED Output	Long Low
Voice Activation	Double Press MFB	No LED Output	One Short

Position the Boom

Do not rotate the boom beyond the stop point.

*Applies to Mono and Binaural Model. The Behind the Neck model has only left side boom placement.



Left Side Boom Placement

Right Side Boom Placement

Adjust Headband

The headband can be squeezed for a tighter or a looser fit to the head. The stainless steel head band will click as it is lengthened or shortened into a comfortable position. When adjusting the headband:

- Position the ear cushion in the center of the ear.
- Position the T-Bar cushion above the ear, half way between the top of the ear and the top of the head.



Headband Disassembly

1. Loosen the Headband Set Screw Counterclockwise
2. Remove Bluetooth Headset Module from Headband Module



Install Windscreen and Ear Cushion



Microphone Orientation

Talk Side



Noise Cancellation Side



Patents

US Patent: 9,813,799, D760,689, D76090, D755,122, and D749,042

 **Bluetooth®** The Bluetooth® word mark and logos are registered trademarks owned by Bluetooth SIG, Inc. and any use of such marks by IDST is under license. Other trademarks and trade names are those of their respective owners.

Operating Specifications

The IDST (Silverback) Bluetooth Headset operates in the Bluetooth Band of 2.402 ~ 2.480 GHz with an RF Output Power of <10dBm.

Cleaning and Maintenance

To maintain the IDST (Silverback) Bluetooth Headset we suggest the following guidelines:

- Do not expose the Headset to harsh chemicals or cleaning agents.
- The Battery must be fully inserted and locked into place in order for it to become IP67 Waterproof. Do NOT immerse the Headset in water beyond 3 feet (1 meter) for beyond 30 minutes per IP-67 Specifications.
- If the Headset becomes dirty, wipe it with a soft damp cloth. Do not use soap, cleaning fluids or chemicals.
- Keep dust, dirt and debris out of the Headset Battery Slot and the Battery Charger Slots.
- When handling the Headset Battery, keep the Battery Contacts free of dirt, grease, oil and other substances that can affect the Battery from making proper contact with the Headset or Charger.
- Battery contacts must be covered with protective sleeve to prevent short circuit and discharge after the Battery is removed from the headset.

Troubleshooting

Operation	Problem	Possible Solution
Operating	Headset will not Turn On.	Make sure Battery is fully seated in Headset.
		Make sure Battery is charged by placing Battery in Battery Charger and following the Battery charging instructions.
		Backup Battery is below minimum operating voltage. Allow 1 minute for Main Battery to charge Backup Battery.
Pairing	Does not Pair.	Headset should be off when beginning pairing process.
		Make sure intended Host's Bluetooth is turned on.
		Make sure Headset is within 12 inches of intended Host.
		Make sure you select " SILVERBACK " on your Host's Bluetooth search menu.
	Headset appears to be connected but cannot communicate with intended Host.	Headset may be connected with different Host. <ol style="list-style-type: none"> 1. Make sure intended Bluetooth Device is within 12 inches of Headset. 2. Make sure all other non-intended Bluetooth Devices are 6 feet away from Headset. 3. Turn off Headset and start pairing process again.
Charging Battery	Battery does not seat properly in the Charging Slot.	Rotate Battery and re-insert into Charging Slot.
	No LEDs Light on Charger when Battery is inserted.	Check Power Cable connection to Charger. Battery may be faulty. Replace Battery.
LED	No LED light visible on Headset.	Press Vol+ for 15 Seconds to turn on LED. Press Vol- for 15 Seconds to turn off LED.
NFC	NFC Does not Pair	For Touch-to-Pair, initiate Standard Bluetooth Pairing before touching Headset NFC tag to NFC tag of Host. NFC Tag is located in Microphone Assembly.

Battery Safety Guidelines

- The area in which the Batteries are charged should be clear of debris and combustible materials or chemicals. Improper Battery use may result in a fire, explosion, or other hazard.
- To charge the Headset Battery, the Battery and Charger temperatures must be between 41°F – 95°F (5°C – 35°C).
- Do not use incompatible Batteries and/or Chargers. Use of an incompatible Battery or Charger may present a risk of fire, explosion, leakage, or other hazard. If you have any questions about the compatibility of a Battery or a Charger, contact your Distributor Customer Support.
- Do not disassemble, open, crush, bend, deform, puncture, or shred.
- Severe impact from dropping any Battery-Operated Device on a hard surface could cause the Battery to overheat.
- Do not short circuit a Battery or allow metallic or conductive objects to contact the Battery terminals. Use the supplied protective Battery Sleeve when Battery is removed from Headset.
- Do not modify or remanufacture, attempt to insert foreign objects into the Battery, immerse or expose to water or other liquids, or expose to fire, explosion, or other hazard.
- Do not leave or store the Battery in or near areas that might get very hot, such as in a parked vehicle, near a radiator or other heat source.
- Do not place Battery into a microwave oven, conventional oven, toaster oven, washer, dryer, dishwasher, or other mechanical devices.
- Battery usage by children should be supervised.
- Please follow local regulations to promptly dispose of used re-chargeable Batteries.
- Do not dispose of Batteries in fire.
- Seek medical advice immediately if a Battery has been swallowed.
- In the event of a Battery leak, do not allow the liquid to come in contact with the skin or eyes. If contact is made, wash the affected area with large amounts of water and seek medical advice.
- If you suspect damage to your Headset or Battery, contact your Distributor Customer Support to arrange for inspection.

Warranty and Customer Support

- For the complete ID Services Taipei LTD hardware product warranty statement, call: +886 2 2219 8415
- If you have problem using your equipment, contact ID Services Taipei LTD Customer Support at call: +886 2 2219 8415
- For the latest version of this User Manual, call: +886 2 2219 8415

Safety and Regulatory Information



- **Warnings for use of Wireless Devices.** Please observe all warning notices with regard to the usage of wireless devices.



- **Potentially Hazardous Atmospheres – Vehicles Use.** You are reminded of the need to observe restrictions on the use of radio devices in fuel depots, chemical plants etc. and areas where the air contains chemicals or particles (such as grain, dust, or metal powders) and any other area where you would normally be advised to **turn off your vehicle engine.**



- **Potentially Hazardous Atmospheres – Fixed Installations.** You are reminded of the need to observe restrictions on the use of radio devices in fuel depots, chemical plants etc. and areas where the air contains chemicals or particles (such as grain, dust, or metal powders).

- Contains small parts which can be a choking hazard.
- Not suitable for children under age 3.
- This product contains magnets which can be harmful to pacemakers, or similar medical devices.
- To reduce the risk of fire or electrical shock, do not expose the product to rain or moisture.
- As with any electronic products, use care not to spill liquids into any part of the system. Liquids can cause a failure and/or a fire hazard.
- Do not place any naked flame sources, such as lighted candles, on or near the apparatus.
- Use caution when using your headset while operating a vehicle or engaging in any activity that requires your full attention. Check and follow local laws regarding mobile phone and headset use. Some jurisdictions impose specific limitations, such as single earpiece configuration, on the use of such products while driving.
- Sounds that you rely on as reminders or warnings may sound different when using a headset. Be aware of how these sounds may vary in character so you can recognize them as needed.

- Do not leave a battery on prolonged charge when not in use.



CAUTION:

Do not make modifications to the headset or accessories. Unauthorized alterations may compromise safety, regulatory compliance, and product performance and warranty.



Prevention of Hearing Loss

To prevent possible hearing damage, do not listen at high volume levels for long periods.

- Use only with the supplied power supply meeting local regulatory requirements (ex. UL, CSA, VDE, CCC).
- Use caution when using a Headset while operating a motor vehicle or anywhere the inability to hear outside sounds may present a danger to you or others.
- The IDST (Silverback) Bluetooth Headset does not require scheduled cleaning. Should cleaning be necessary, simply wipe the outside surfaces with a soft damp cloth.

Regulatory Information

All ID Services Taipei LTD devices are designed to be compliant with rules and regulations in the locations they are sold and will be labeled as required. This regulatory information applies to Model number IDBHS1-.

International

This device complies with internationally recognized standards covering human exposure to electromagnetic fields from radio devices.

Wireless Device Country Approvals

Regulatory markings, subject to certification, are applied to the device signifying the radio (s) is/are approved for use in the following countries: United States, Canada, and Europe.

Note: Europe includes Austria, Belgium, Bulgaria, Czech Republic, Cyprus, Denmark, Estonia, Finland, France, Germany, Greece, Hungary, Iceland, Ireland, Italy, Latvia, Liechtenstein, Lithuania, Luxembourg, Malta, Netherlands, Norway, Poland, Portugal, Romania, Slovak Republic, Slovenia, Spain, Sweden, Switzerland and the United Kingdom.



CE NOTICE TO USERS

ID Services Taipei LTD hereby declares that this product is in compliance with the essential requirements and other relevant provisions EU RED - DIRECTIVE 2014/53/EU & EU-LOW VOLTAGE DIRECTIVE 2014/35/EU and all other applicable EU directive requirements.



FCC NOTICE TO USERS

This device complies with FCC and Industry Canada RF radiation exposure limits set forth for general population. It must not be co-located or be operating in conjunction with any other antenna or transmitter.

In the United States:

This equipment has been tested and found to comply with the limits for a Class B digital device, pursuant to Part 15 of the FCC Rules. These limits are designed to provide reasonable protection against harmful interference in a residential installation. This equipment generates, uses, and can radiate radio frequency energy and, if not installed and used in accordance with the instructions, may cause harmful interference to radio communications.

However, this is no guarantee that interference will not occur in a particular installation. If this equipment does cause harmful interference to radio or television reception, which can be determined by turning the equipment off and on, you are encouraged to try to correct the interference by one or more of the following measures:

- Reorient or relocate the receiving antenna.
- Increase the separation between the equipment and receiver.
- Connect the Headset Charger to an outlet on a different circuit than the one to which the receiver is connected.
- Consult the dealer or an experienced radio/TV technician for help.

Changes or modifications not expressly approved by ID Services Taipei LTD could void the user's authority to operate this equipment.

In USA and Canada:

This device complies with part 15 of the FCC rules and Industry Canada license-exempt RSS standard(s). Operation is subject to the following two conditions:

1. This device may not cause harmful interference.
2. This device must accept any interference received, including interference that may cause undesired operation.

Le présent appareil est conforme aux CNR d'Industrie Canada applicables aux appareils radio exempts de licence. L'exploitation est autorisée aux deux conditions suivantes:

1. l'appareil ne doit pas produire de brouillage, et
2. l'utilisateur de l'appareil doit accepter tout brouillage radioélectrique subi, même si le brouillage est susceptible d'en compromettre le fonctionnement.

This class B digital apparatus complies with CAN ICES-3 (B) / NMB-3 (B)



Waste Electrical and Electronic Equipment

This symbol on the product or on its packaging indicates that this product must not be disposed of with your other household waste. Instead, it is your responsibility to dispose of your waste equipment by handing it over to a designated collection point for the recycling of waste electrical and electronic equipment. The separate collection and recycling of your waste equipment at the time of disposal will help to conserve natural resources and ensure that it is recycled in a manner that protects human health and the environment.